

SEE MAP 512-02\_4

SEE MAP 512-02\_1

DESERT GREENS DR.

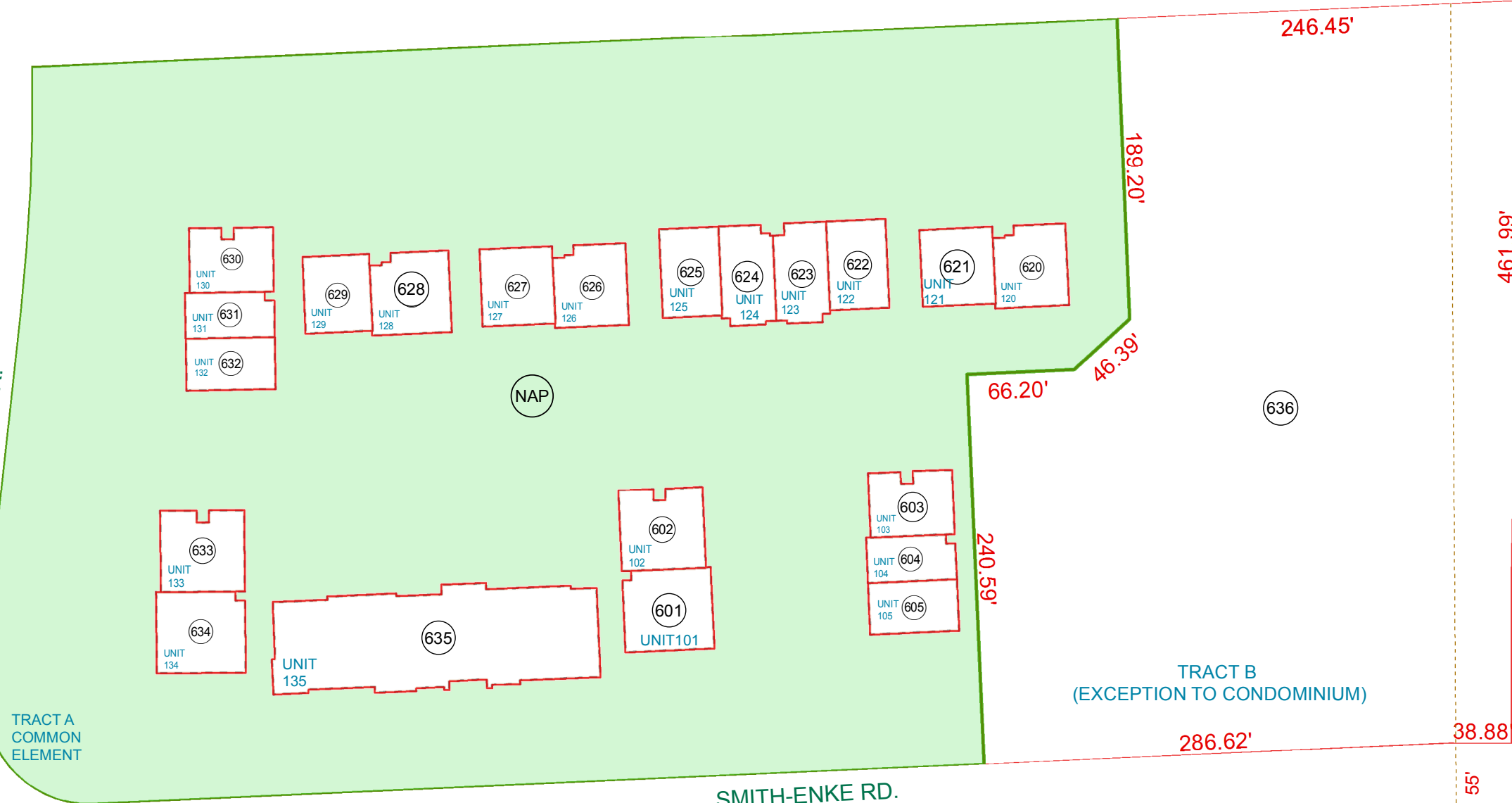

SECTION 14  
SECTION 13

SEE MAP 510-12\_3

TRACT A  
COMMON  
ELEMENT

TRACT B  
(EXCEPTION TO CONDOMINIUM)

SMITH-ENKE RD.

SE CORNER  
SECTION 14

SEE MAP 512-07\_1

BOOK - MAP

# 512-02\_5

**S2 SE SE SEC. 14 T.04S R.03E**  
**MARICOPA GRAND PROFESSIONAL**  
**VILLAGE A CONDOMINIUM: CABINET H - SLIDE 075**  
**REPLAT OF MARICOPA GRAND**  
**PROFESSIONAL VILLAGE A CONDOMINIUM:**  
 2011-029310  
**AMENDED REPLAT OF REPLAT OF**  
**MARICOPA GRAND PROFESSIONAL**  
**VILLAGE: 2017-013851**

LOCATION MAPS  
R.E.

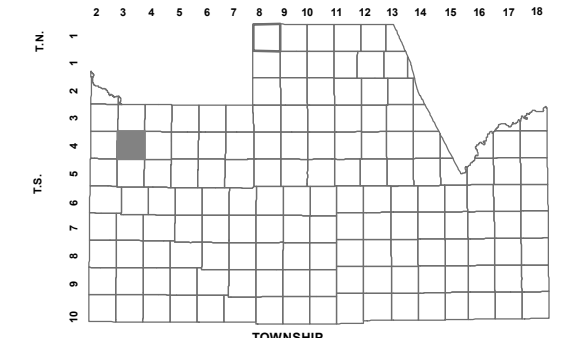

6	5	4	3	2	1
7	8	9	10	11	12
18	17	16	15	14	13
SMITH-ENKE RD	20	21	22	23	24
HONEYCUTT RD	29	28	27	26	25
30	32	33	34	35	36
31	32	33	34	35	36

SECTION

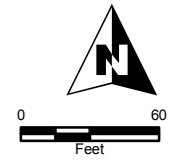

Revised: 7/6/2017

By: MBG



PINAL COUNTY  
*wide open opportunity*

**Pinal County Assessor**

THIS MAP DOES NOT REPRESENT A SURVEY. NO LIABILITY IS ASSUMED FOR THE ACCURACY OF THE DATA DELINEATED HEREIN, EITHER EXPRESSED OR IMPLIED BY PINAL COUNTY OR ITS EMPLOYEES. THIS MAP IS COMPILED FROM OFFICIAL RECORDS, INCLUDING PLATS, SURVEYS, RECORDED DEEDS AND CONTRACTS, AND ONLY CONTAINS INFORMATION REQUIRED FOR THE PINAL COUNTY ASSESSOR'S OFFICE PURPOSES.