

SEE MAP 504-31_1

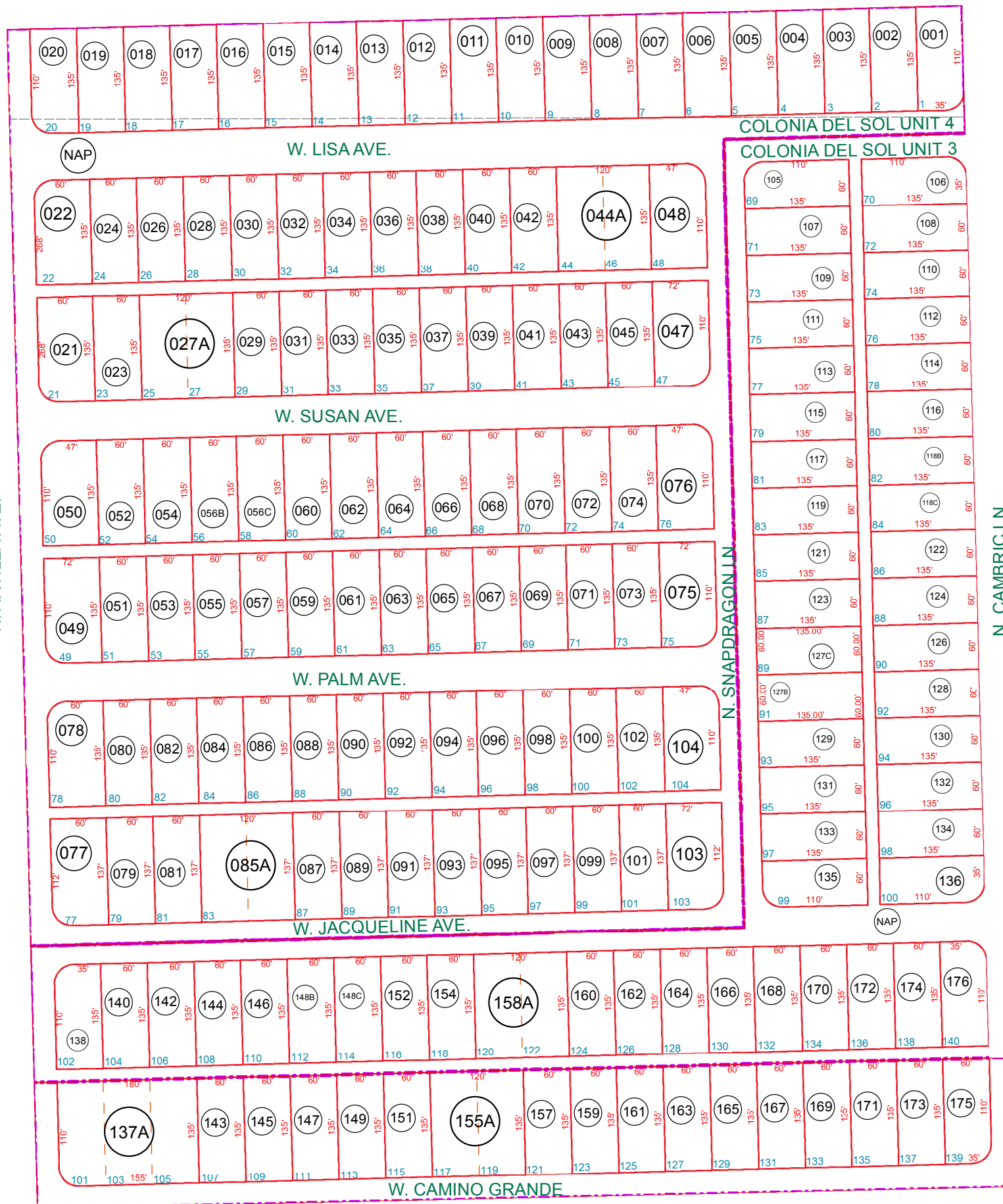

SEE MAP 504-28
N. ARVILLA AVE.

N. CAMBRIC LN
SEE MAP 504-26

SEE MAP 504-03

BOOK - MAP

504-27

N2 SEC. 6 T.06S. R.06E.

COLONIA DEL SOL UNIT 3
BK 15 - PG 018

COLONIA DEL SOL
UNIT 3
BK 15 - PG 018

LOCATION MAPS
R.E.

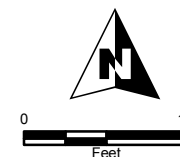
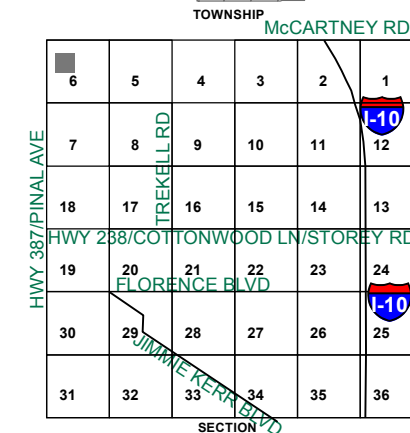
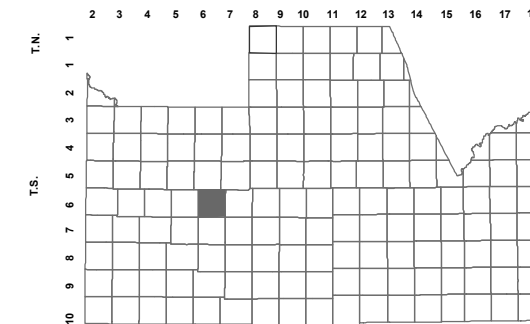

Revised: 10/3/2017

By: **K G**



PINAL COUNTY
WIDE OPEN OPPORTUNITY

Pinal County Assessor

THIS MAP DOES NOT REPRESENT A SURVEY. NO LIABILITY IS ASSUMED FOR THE ACCURACY OF THE DATA DELINEATED HEREIN, EITHER EXPRESSED OR IMPLIED BY PINAL COUNTY OR ITS EMPLOYEES. THIS MAP IS COMPILED FROM OFFICIAL RECORDS, INCLUDING PLATS, SURVEYS, RECORDED DEEDS AND CONTRACTS, AND ONLY CONTAINS INFORMATION REQUIRED FOR THE PINAL COUNTY ASSESSOR'S OFFICE PURPOSES.