

SEE MAP 503-39

CORRALES RD



SEE MAP 503-70_3

CRESCET AVE

CONQUIRO AVE

ALMIRNITE DR

CANDLESTICK DR

CHARTER OAK AVE

ALMIRNITE DR

AGUADILLA DR

AGUADILLA DR

ANASCO DR

TRACT 3

465C TRACT 4

465C

TRT 7
465C

TRT 6
465C

SEE MAP 503-50

SEE MAP 530-70_1

COMMON AREA PARCEL: 503-70-465C
ASSESSOR'S TRACTS 1 THROUGH 4,
6 THROUGH 8 AND 12 & 13

BOOK - MAP

503-70_2

SW SW SEC. 21 T.06S. R.05E.
DESERT CARMEL SECTION A
BK 14 - PG 021

LOCATION MAPS
R.E.

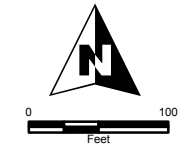
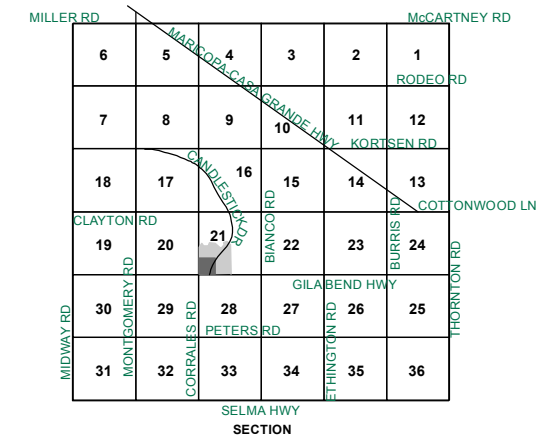
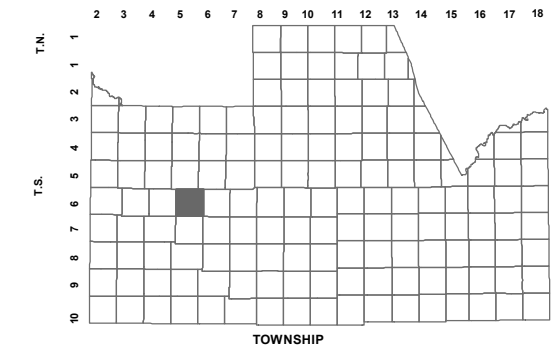

Revised: 9/01/2016
By: HY



PINAL COUNTY
wide open opportunity

Pinal County Assessor

THIS MAP DOES NOT REPRESENT A SURVEY. NO LIABILITY IS ASSUMED FOR THE ACCURACY OF THE DATA DELINEATED HEREIN, EITHER EXPRESSED OR IMPLIED BY PINAL COUNTY OR ITS EMPLOYEES. THIS MAP IS COMPILED FROM OFFICIAL RECORDS, INCLUDING PLATS, SURVEYS, RECORDED DEEDS AND CONTRACTS, AND ONLY CONTAINS INFORMATION REQUIRED FOR THE PINAL COUNTY ASSESSOR'S OFFICE PURPOSES.