

MARICOPA COUNTY

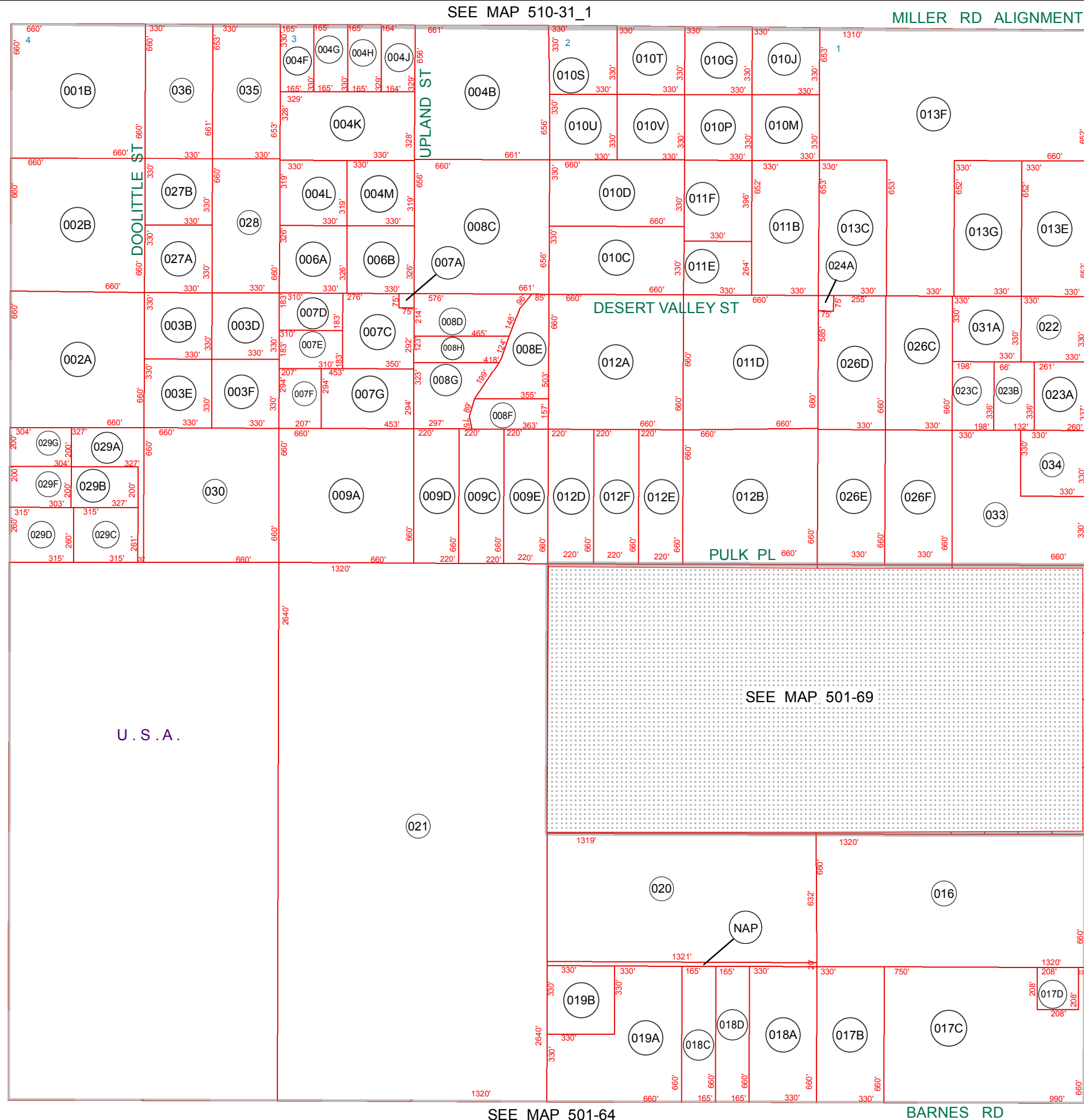

BOOK - MAP
501-67
 SEC. 5 T.06S. R.02E.

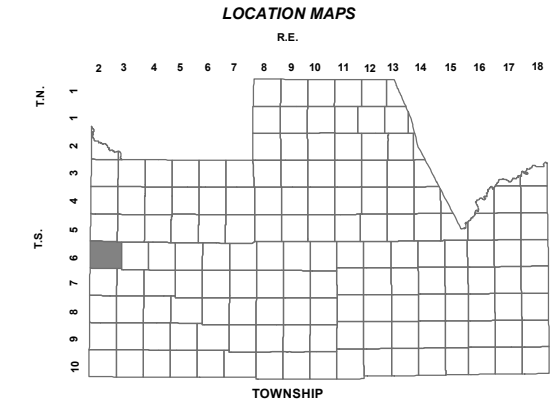

MILLER RD					
6	5	4	3	2	1
	SAGE ST	BARNES RD		RALSTON RD	AMARILLO VALLEY RD
7	8	9	10	11	12
		HIDDEN VALLEY RD		MEADOW GREEN RD	
18	17	16	15	14	13
				CENTURY RD	
19	20	21	22	23	24
				DUNE SHADOW RD	
30	29	28	27	26	25
			WARREN RD	FRESNO RD	
31	32	33	34	35	36
			ROBIN RD		
SECTION					

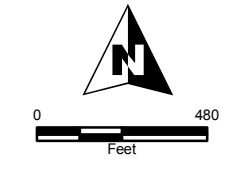

Revised: 2/20/2014

By: CM



PINAL COUNTY
wide open opportunity

Pinal County Assessor

THIS MAP DOES NOT REPRESENT A SURVEY. NO LIABILITY IS ASSUMED FOR THE ACCURACY OF THE DATA DELINEATED HEREIN, EITHER EXPRESSED OR IMPLIED BY PINAL COUNTY OR ITS EMPLOYEES. THIS MAP IS COMPILED FROM OFFICIAL RECORDS, INCLUDING PLATS, SURVEYS, RECORDED DEEDS AND CONTRACTS, AND ONLY CONTAINS INFORMATION REQUIRED FOR THE PINAL COUNTY ASSESSOR'S OFFICE PURPOSES.

SEE MAP 501-47

SEE MAP 501-48

SEE MAP 501-69