

# 210-73\_4

SEC. 27 T.03S. R.08E.  
THE VILLAGE AT COPPER BASIN  
UNIT 3B  
CABINET E - SLIDE 31

LOCATION MAPS  
R.E.

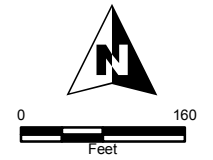
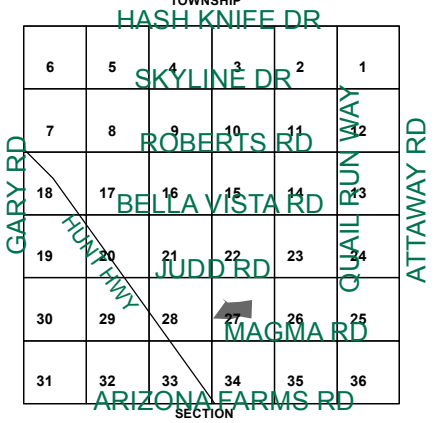
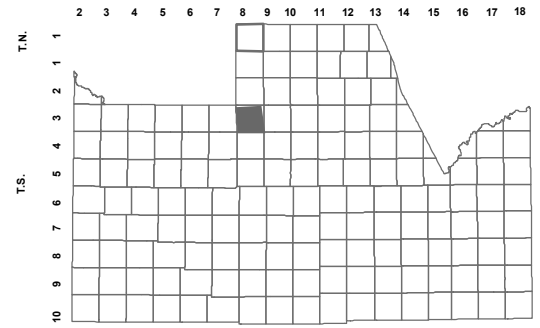

Revised: 6/15/2012

By: YL



PINAL COUNTY  
wide open opportunity

Pinal County Assessor

THIS MAP DOES NOT REPRESENT A SURVEY. NO LIABILITY IS ASSUMED FOR THE ACCURACY OF THE DATA DELINEATED HEREIN, EITHER EXPRESSED OR IMPLIED BY PINAL COUNTY OR ITS EMPLOYEES. THIS MAP IS COMPILED FROM OFFICIAL RECORDS, INCLUDING PLATS, SURVEYS, RECORDED DEEDS AND CONTRACTS, AND ONLY CONTAINS INFORMATION REQUIRED FOR THE PINAL COUNTY ASSESSOR'S OFFICE PURPOSES.

SEE MAP 210-25

SEE MAP 210-25

SEE MAP 210-25

COMMON AREA PARCEL 210-67-499C  
COPPER BASIN UNIT ONE  
TRACTS: A, B, C, E, F, G, H, I, J & K  
THE VILLAGE AT COPPER BASIN UNIT 2  
TRACTS: A & B  
THE VILLAGE AT COPPER BASIN UNIT 3A  
TRACTS: A THRU T  
THE VILLAGE AT COPPER BASIN UNIT 3B  
TRACTS: A THRU M  
THE VILLAGE AT COPPER BASIN UNIT 4  
TRACTS: 4A THRU 4L  
THE VILLAGE AT COPPER BASIN UNIT 5A  
TRACTS: A THRU R  
COLLECTOR ROADS, PARCELS, COMMON TRACTS & ESMTS FOR  
THE VILLAGE @ COPPER BASIN UNIT 3  
TRACTS: A, B, C, E, F & G

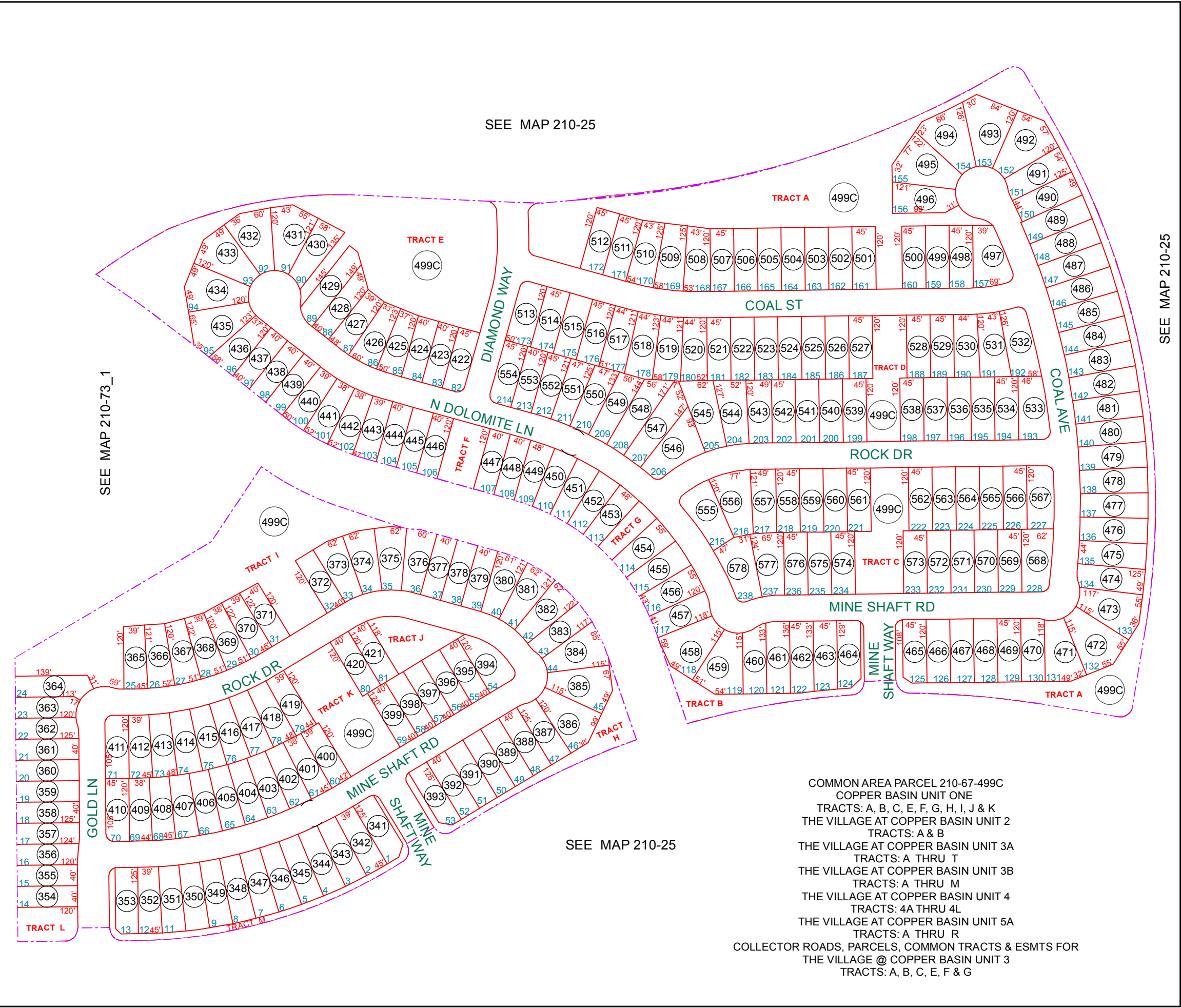

SEE MAP 210-73\_1