

# SEC. 7 TN.5S RG.8E

SEE MAP 209-06

# 209-07

AREA CODE  
2103  
2107

SPECIAL DISTRICTS  
12662  
16601

THIS MAP IS FOR TAX PURPOSES ONLY  
THIS OFFICE WILL NOT ASSUME LIABILITY FOR  
REPRESENTATION, MEASUREMENTS OR ACREAGE.

SEE BOOK 509

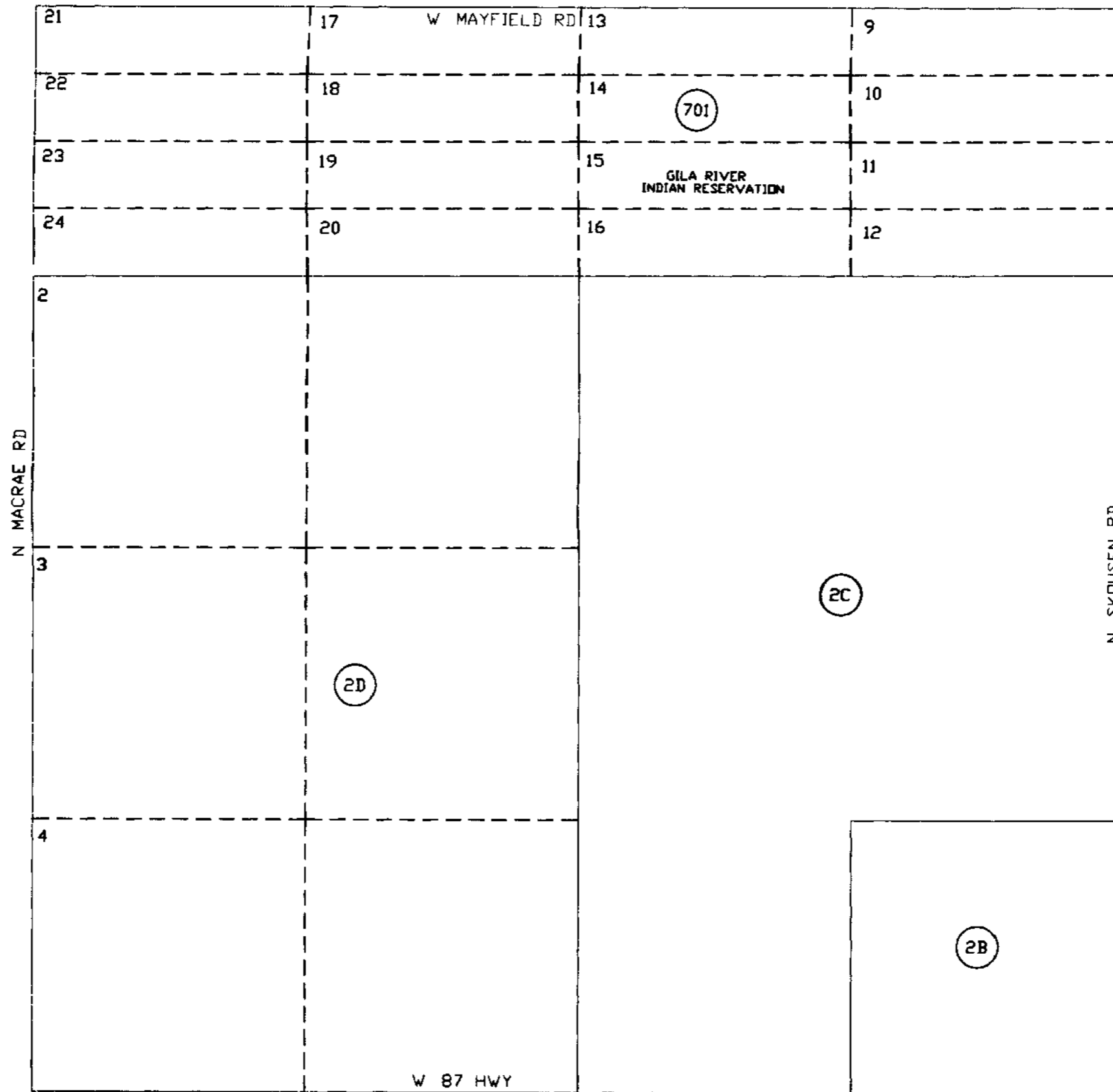

SEE MAP 209-08

THE ORIGINAL PLAT OF THIS SUBDIVISION IS  
ON FILE WITH THE PINAL COUNTY RECORDERS  
OFFICE, FOR COMPLETE INFORMATION OF PLAT  
AND CC&R'S CALL (520) 866-7100.

## VICINITY MAP

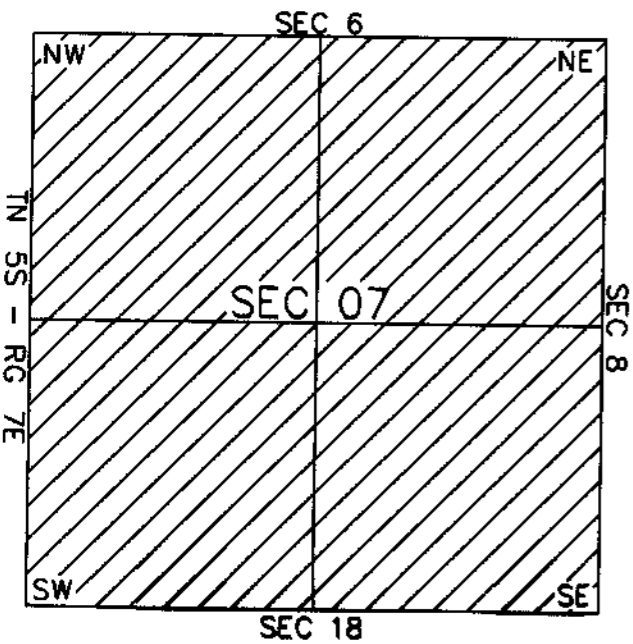

W 87 HWY

SEE MAP 209-18



SCALE: 1" = 600'

09-03-2001

PINAL COUNTY ASSESSORS MAP