

# SEC. 6 TN.5S RG.8E

SEE BOOK 200

# 209-06

AREA CODE  
2103  
2107

SPECIAL DISTRICTS  
12662  
16601

THIS MAP IS FOR TAX PURPOSES ONLY

THIS OFFICE WILL NOT ASSUME LIABILITY FOR  
REPRESENTATION, MEASUREMENTS OR ACREAGE.

SEE BOOK 509

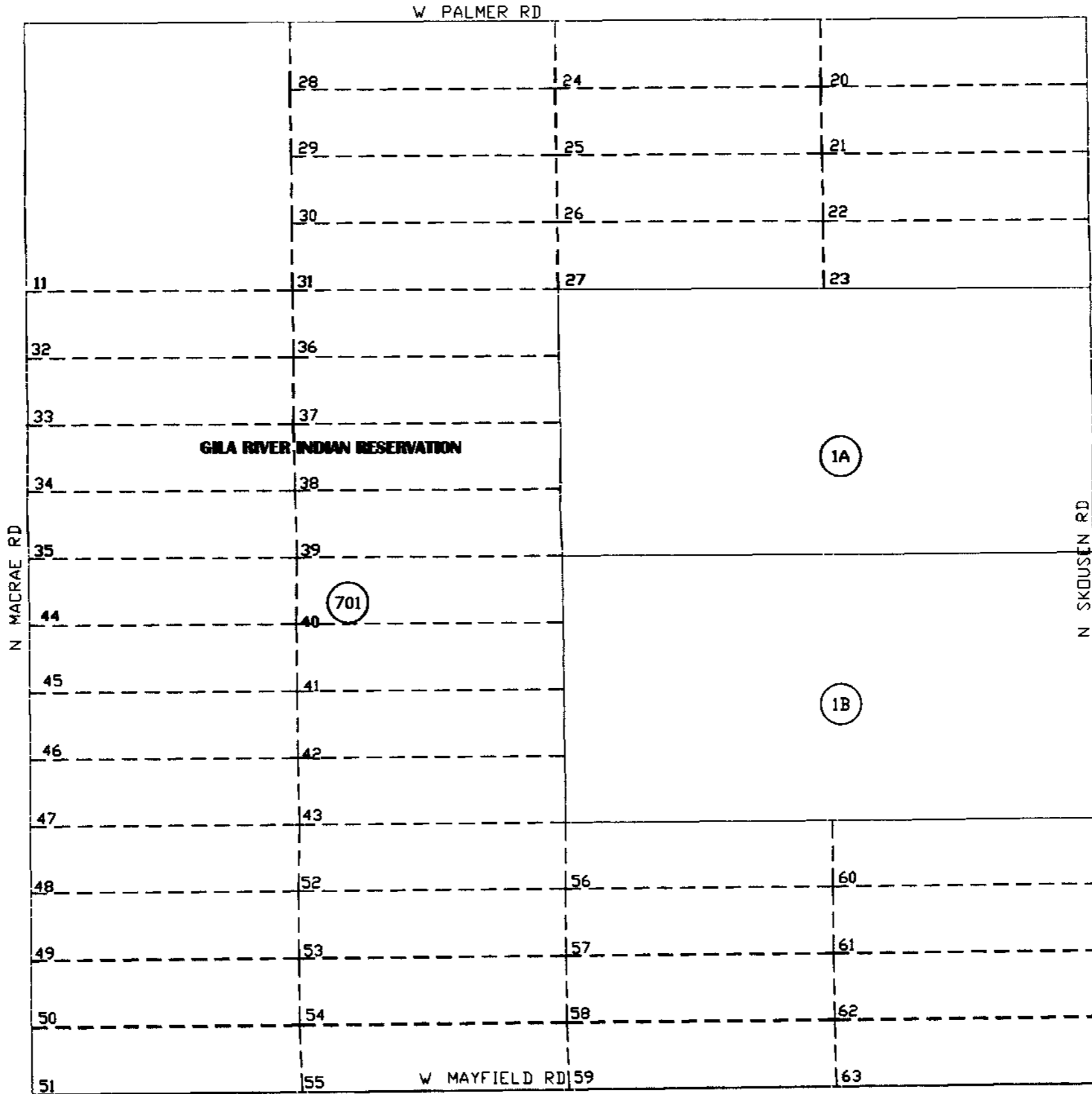

THE ORIGINAL PLAT OF THIS SUBDIVISION IS  
ON FILE WITH THE PINAL COUNTY RECORDERS  
OFFICE, FOR COMPLETE INFORMATION OF PLAT  
AND OCMR: CALL (602) 868-7100.

SEE MAP 209-05

## VICINITY MAP

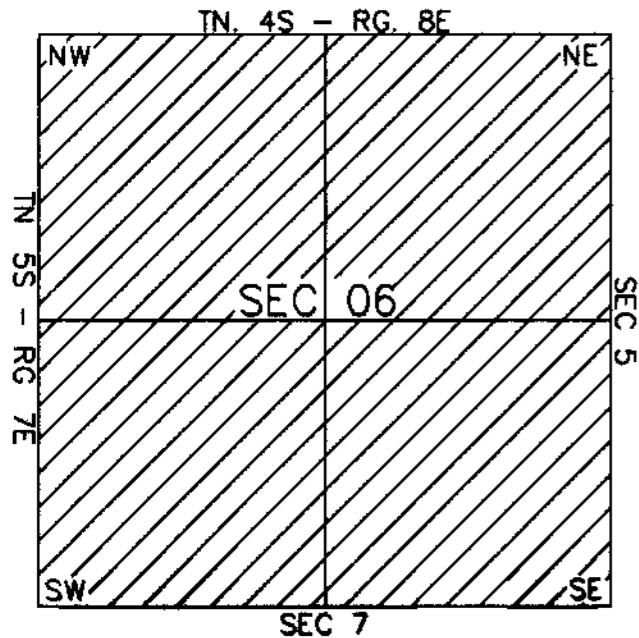

SCALE: 1" = 600'

09-03-2001

SEE MAP 209-07

PINAL COUNTY ASSESSOR'S MAP