

SEC. 36 TN.5S RG.8E

SEE MAP 209-23

209-36

E MARTIN RD

AREA CODE
2102
2103

SPECIAL DISTRICTS
12662
16601

THIS MAP IS FOR TAX PURPOSES ONLY

THIS OFFICE WILL NOT ASSUME LIABILITY FOR REPRESENTATION, MEASUREMENTS OR ACREAGE.

SEE MAP 209-35

N NAFZIGER RD

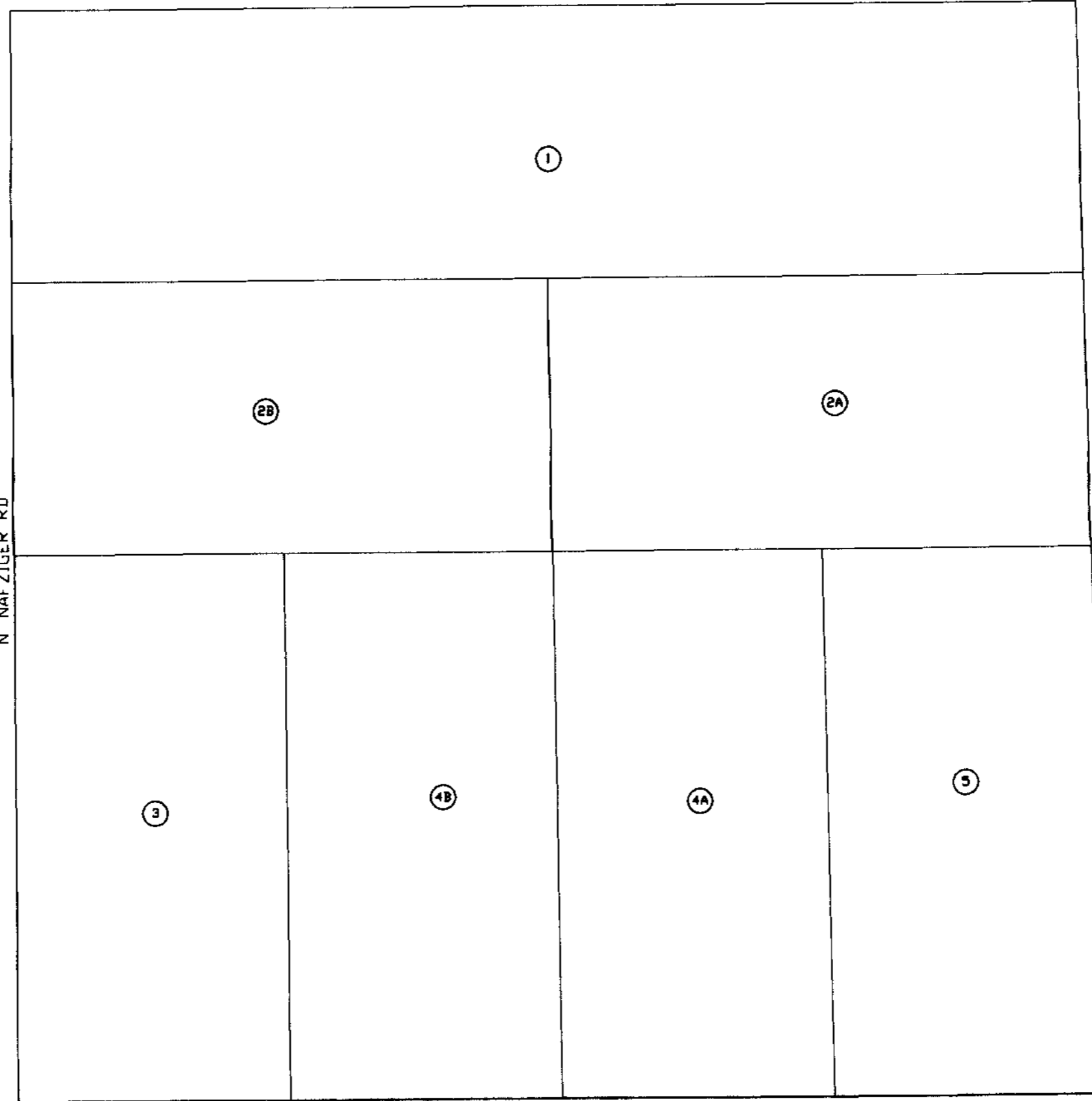

N ATTAWAY RD

SEE BOOK 202

THE ORIGINAL PLAT OF THIS SUBDIVISION IS ON FILE WITH THE PINAL COUNTY RECORDERS OFFICE, FOR COMPLETE INFORMATION OF PLAT AND C&R'S CALL (520) 868-7100.

VICINITY MAP

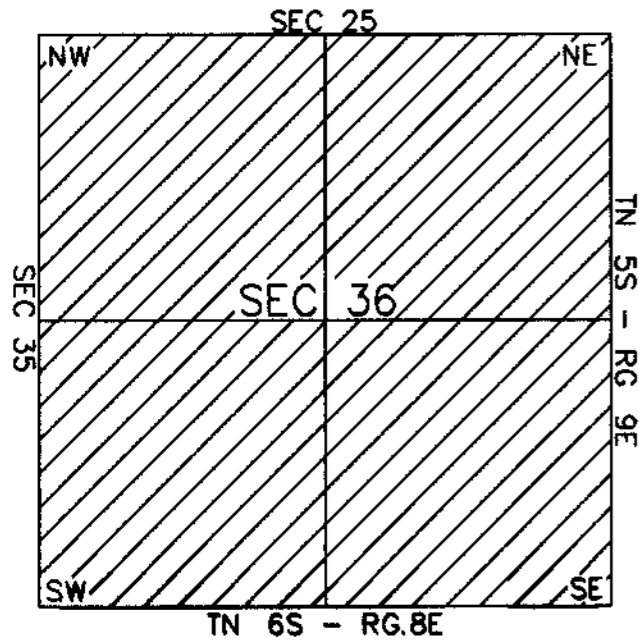

E BARTLETT RD

SEE BOOK 401



SCALE 1" = 600'

09-03-2001

PINAL COUNTY ASSESSORS MAP