

SEE MAP 104-57

016L

016M

016Y

028

016Z

016X

PERALTA CANYON
PARCEL 4
SEE MAPS 104-09_9

PERALTA CANYON
PARCEL 1
SEE MAPS 104-09_7 & 8

PERALTA CANYON
PARCEL 5
SEE MAP 104-09_12

PERALTA CANYON
PARCEL 6
SEE MAP 104-09_6

SEE MAP 104-09_10

PERALTA CANYON
PARCEL 2

SEE MAP 104-09_11

PERALTA
CANYON
PARCEL 3
SEE MAP 104-09_5

PERALTA TRAILS UNIT III-A
SEE MAP 108-74_10

PERALTA TRAILS
UNIT 1
SEE MAPS 108-74_1, _2, _3, _4, _5

PERALTA PRESERVE
UNIT 2
SEE MAPS 108-74_6, _7, _8

PERALTA PRESERVE
UNIT II-A
SEE MAP 108-74_9

HWY 60

SEE MAP 104-09_1

SEE MAP 104-09_1

SEE MAP 104-09_1

BOOK - MAP

104-09_4

SEC. 16 T.01S. R.09E.

LOCATION MAPS

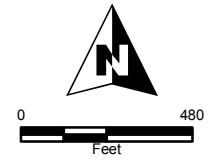
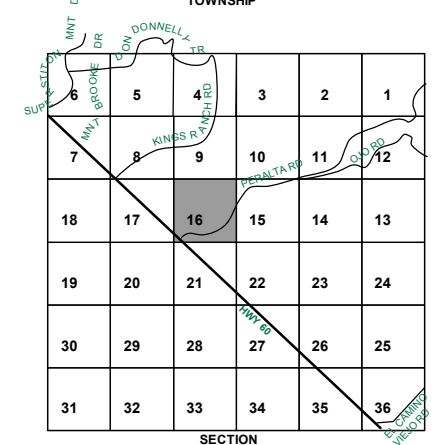
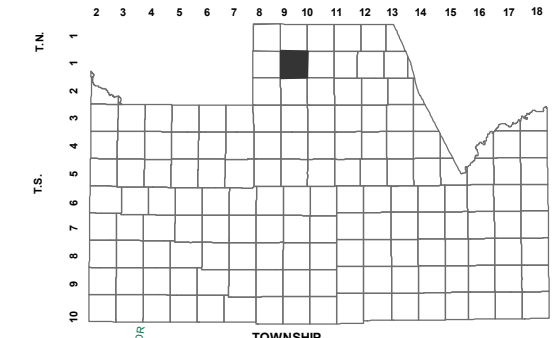

Revised: 1/24/2018

By: **DW**



PINAL COUNTY

WIDE OPEN OPPORTUNITY

Pinal County Assessor

THIS MAP DOES NOT REPRESENT A SURVEY. NO LIABILITY IS ASSUMED FOR THE ACCURACY OF THE DATA DELINEATED HEREIN, EITHER EXPRESSED OR IMPLIED BY PINAL COUNTY OR ITS EMPLOYEES. THIS MAP IS COMPILED FROM OFFICIAL RECORDS, INCLUDING PLATS, SURVEYS, RECORDED DEEDS AND CONTRACTS, AND ONLY CONTAINS INFORMATION REQUIRED FOR THE PINAL COUNTY ASSESSOR'S OFFICE PURPOSES.