

104-24_5

N2 NW NE SEC. 17 T.02S. R.08E.

BELCARA SUBDIVISION @
PIMA ROAD: CAB G - SLD 193

BELCARA SUBDIVISION @
PIMA ROAD REPLAT OF
LOTS 1 THRU 46: 2013-077344

LOCATION MAPS
R.E.

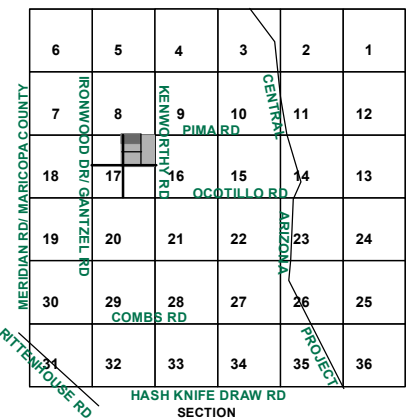
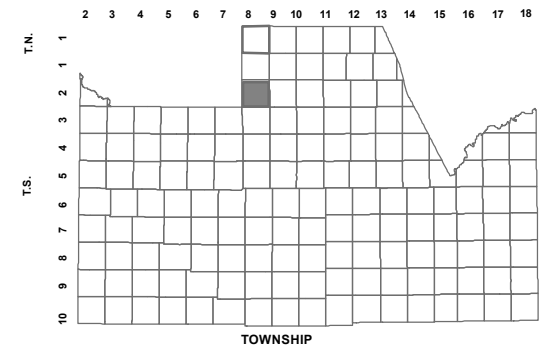

Revised: 10/23/2013

By: MBG



PINAL COUNTY
wide open opportunity

Pinal County Assessor

THIS MAP DOES NOT REPRESENT A SURVEY. NO LIABILITY IS ASSUMED FOR THE ACCURACY OF THE DATA DELINEATED HEREIN, EITHER EXPRESSED OR IMPLIED BY PINAL COUNTY OR ITS EMPLOYEES. THIS MAP IS COMPILED FROM OFFICIAL RECORDS, INCLUDING PLATS, SURVEYS, RECORDED DEEDS AND CONTRACTS, AND ONLY CONTAINS INFORMATION REQUIRED FOR THE PINAL COUNTY ASSESSOR'S OFFICE PURPOSES.

SEE MAP 104-23



SEE MAP 104-24_1

SEE MAP 104-24_1

SEE MAP 104-24_1

TRACTS A THRU D &
F THRU H ARE
UNDER PARCEL: 104-24-371

(TRACT D IS PRIVATE ROW)

TRACT E IS UNDER PARCEL: 104-24-372