

103-34_2

NE SE SEC. 34 T.01N. R.08E.
DESERT SUN CONDOMINIUM
CAB. B - SLD. 061

LOCATION MAPS
R.E.

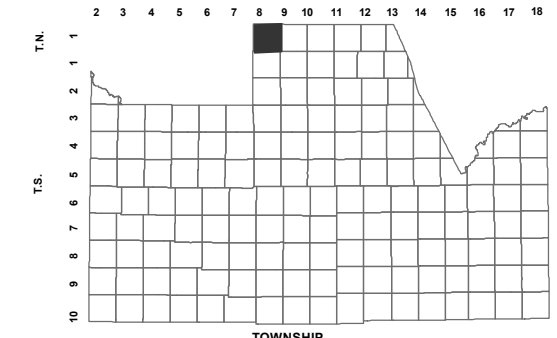

TOWNSHIP

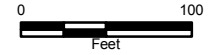
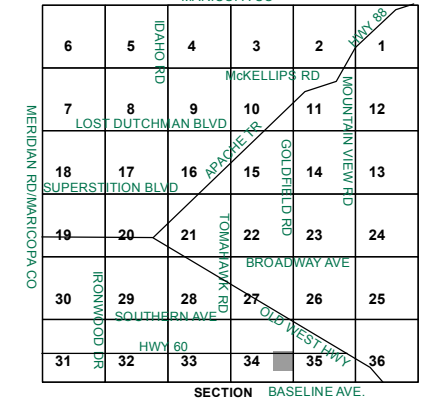

Revised: 11/20/2017

By: **TH**



PINAL COUNTY
WIDE OPEN OPPORTUNITY

Pinal County Assessor

THIS MAP DOES NOT REPRESENT A SURVEY. NO LIABILITY IS ASSUMED FOR THE ACCURACY OF THE DATA DELINEATED HEREIN, EITHER EXPRESSED OR IMPLIED BY PINAL COUNTY OR ITS EMPLOYEES. THIS MAP IS COMPILED FROM OFFICIAL RECORDS, INCLUDING PLATS, SURVEYS, RECORDED DEEDS AND CONTRACTS, AND ONLY CONTAINS INFORMATION REQUIRED FOR THE PINAL COUNTY ASSESSOR'S OFFICE PURPOSES.

SEE MAP 103-23

TRACT A

724 (188)	722 (186)	720 (184)	718 (182)	716 (180)	714 (158)
624 (144)	622 (142)	620 (140)	618 (138)	616 (136)	614 (134)
723 (167)	721 (165)	719 (163)	717 (161)	715 (159)	713 (157)
623 (143)	621 (141)	619 (139)	617 (137)	615 (135)	613 (133)

324 (072)	322 (070)	320 (068)	318 (066)	316 (064)	314 (062)
224 (048)	222 (046)	220 (044)	218 (042)	216 (040)	214 (038)
323 (071)	321 (069)	319 (067)	317 (065)	315 (063)	313 (061)
223 (047)	221 (045)	219 (043)	217 (041)	215 (039)	213 (037)

TRACT A

UPSTAIRS UNITS

823 (191)	821 (189)	819 (187)	817 (185)	815 (183)	813 (181)
824 (192)	822 (190)	820 (188)	818 (186)	816 (184)	814 (182)

523 (119)	521 (117)	519 (115)	517 (113)	515 (111)	513 (109)
524 (120)	522 (118)	520 (116)	518 (114)	516 (112)	514 (110)

423 (095)	421 (093)	419 (091)	417 (089)	415 (087)	413 (085)
424 (096)	422 (094)	420 (092)	418 (090)	416 (088)	414 (086)

123 (023)	121 (021)	119 (019)	117 (017)	115 (015)	113 (013)
124 (024)	122 (022)	120 (020)	118 (018)	116 (016)	114 (014)

GOLDFIELD RD

SEE MAP 103-35_3

DOWNSTAIRS UNITS
SEE MAP 103-34_1

SEE MAP 103-22_1

SEE MAP 103-01_2